

MAP 8.3 PROPOSED LAND USE

- TOWN OF BUENA VISTA -

RICHLAND COUNTY, WISCONSIN

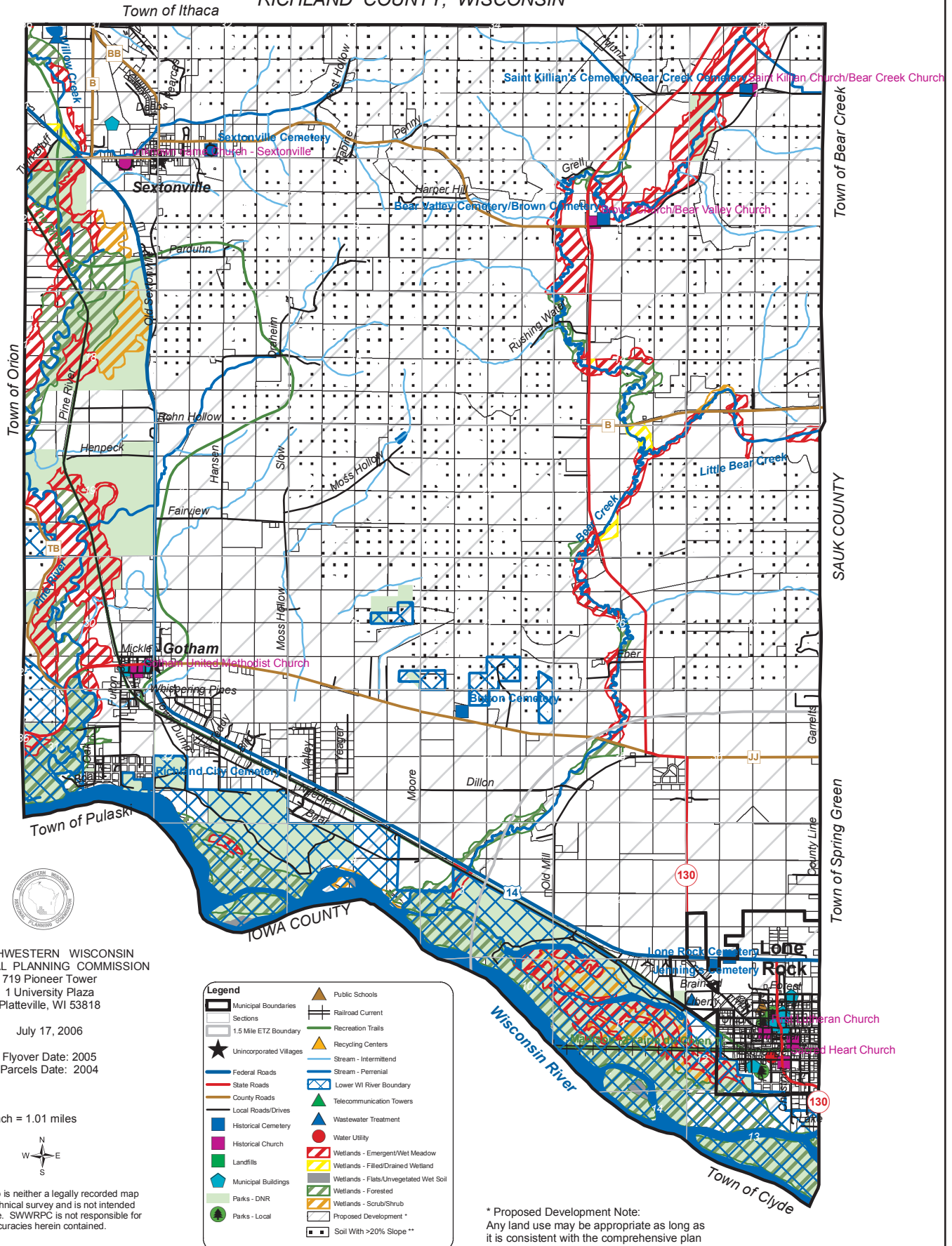

SOUTHWESTERN WISCONSIN
REGIONAL PLANNING COMMISSION
719 Pioneer Tower
1 University Plaza
Platteville, WI 53818

July 17, 2006

Flyover Date: 2005
Parcels Date: 2004

1 inch = 1.01 miles



This map is neither a legally recorded map nor a technical survey and is not intended to be one. SWWRPC is not responsible for any inaccuracies herein contained.

Legend	
	Municipal Boundaries
	Sections
	1.5 Mile ETZ Boundary
	Unincorporated Villages
	Federal Roads
	Slate Roads
	County Roads
	Local Roads/Drives
	Historical Cemetery
	Historical Church
	Landfills
	Municipal Buildings
	Parks - DNR
	Parks - Local
	Public Schools
	Railroad Current
	Recreation Trails
	Recycling Centers
	Stream - Intermittent
	Stream - Perennial
	Lower WI River Boundary
	Telecommunication Towers
	Wastewater Treatment
	Water Utility
	Wetlands - Emergent/Wet Meadow
	Wetlands - Filled/Drained Wetland
	Wetlands - Flats/Unvegetated Wet Soil
	Wetlands - Forested
	Wetlands - Scrub/Shrub
	Proposed Development *
	Soil With >20% Slope **

** Slope Note: The slopes shown were developed by NRCS are general. A technical slope map should be reviewed to confirm slope at specific locations.

* Proposed Development Note:
Any land use may be appropriate as long as it is consistent with the comprehensive plan and local/county ordinances, and state regulations.